

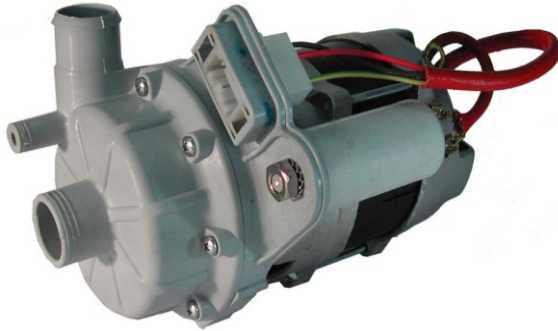

ZFCi121A

kW 0.33
Hp 0.45

Hm 7.6 max
L/1' 138 max



Corpo pompa Pump Body Pumpengehaus	PP 30 GF
Girante Aperta Open Impeller Ø73 Offenes Laufrad	SPS G30
Albero motore Motor Shaft Motorwelle	AISI 430 F
Tenuta meccanica. Mechanical Seal Gleitringdichtung	GRAFITE/CERAMICA CARBON/CERAMIC KOHLE/KERAMIK

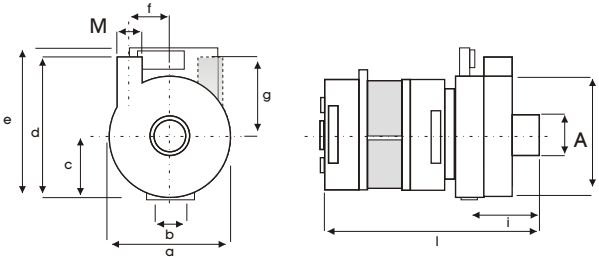

SX	A1	M1	DX	A1	M1	kg										
	L2	28	28		L2	28	28									
mod	a	b	c	d	e	f	g	h	i	l	m	n	o			kg
ZF121	102	24,5	51,2	121	132	27,5	70,1	102	65	196						3,0

Potenza motore Motor power Motor Leistung	Hp 0,45 kW 0,33
Tensione/Frequenza Tension/Frequency Spannung/Frequenz	1~V/Hz 230/50
Corrente assorbita Power consumption Stromaufnahme	A 1,48
GPM RPM UPM	2800
Condensatore Motor Power Motor Leistung	8 µF
Protezione termica Thermal Overload Überlastschutz	155 °C
Classe isolamento Insulation class Isolationsklasse	F
Grado protezione Protection class Schutzklasse	IP 00
Servizio Duty Betriebsart	S1 CONTINUO CONTINUOUS DAUERBETRIEB

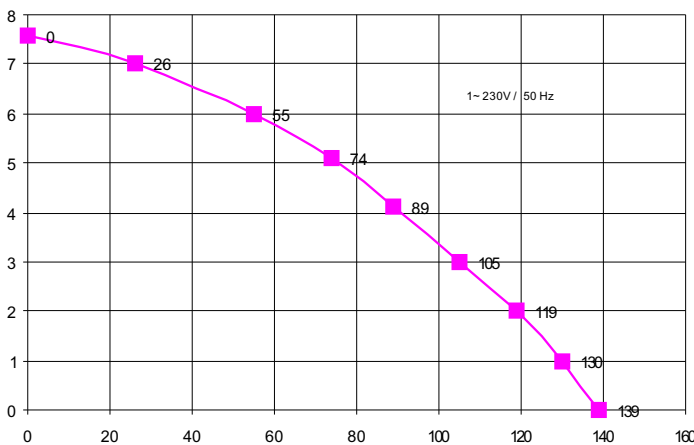

H m	0	1	2	3	4	5	6	7,6
L / 1'	139	130	119	105	89	74	55	0

Ci riserviamo il diritto di apportare e modifiche tecniche
We reserve the right of technical modifications
Technische Änderungen vorbehalten

REVISIONE N.03.01/03